

DESIGNED BY
DRAWN BY
CHECKED BY

COMPOSITE
OVERLAY
PROVIDE
FILE

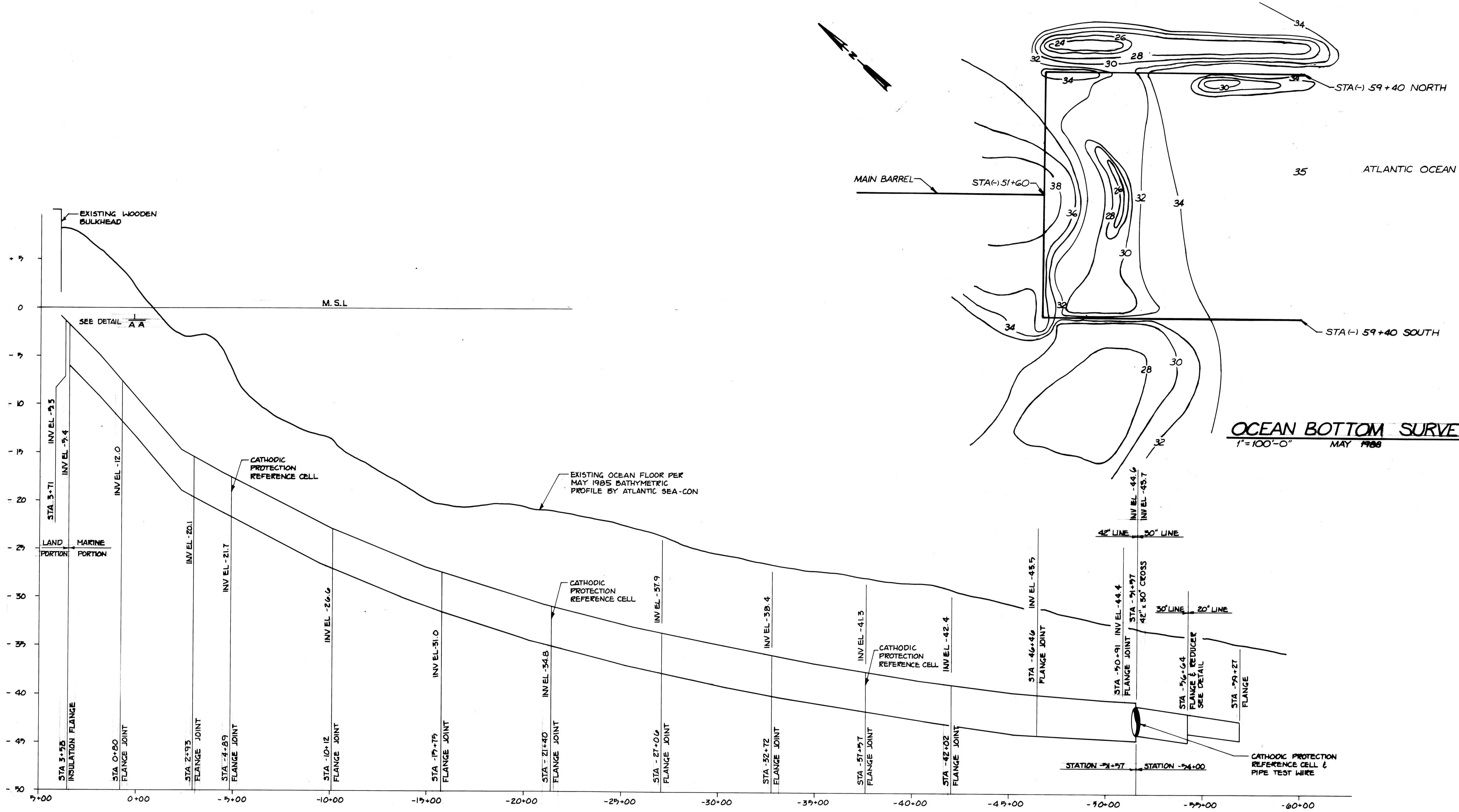

RECORD DRAWINGS

Revisions Drawn by *D. Harrick* Date *Feb 22, 1988*

THESE RECORD DRAWINGS HAVE BEEN PREPARED, IN PART, ON THE BASIS OF INFORMATION COMPILED BY OTHERS. THEY ARE NOT INTENDED TO REPRESENT IN DETAIL THE EXACT LOCATION, TYPE OF COMPONENT NOR MANNER OF CONSTRUCTION. THE ENGINEER WILL NOT BE RESPONSIBLE FOR ANY ERRORS OR OMISSIONS WHICH HAVE BEEN INCORPORATED INTO THE RECORD DRAWINGS.



DSGN	B. ALTARATZ				
DR	A. DURLLEY				
CHK	W. ELMER				
APVD	V. RYBEL	NO.	DATE	REVISION	BY

REUSE OF DOCUMENTS
THIS DOCUMENT, AND THE IDEAS AND DESIGNS INCORPORATED HEREIN, AS AN INSTRUMENT OF PROFESSIONAL SERVICE, IS THE PROPERTY OF CHM HILL AND IS NOT TO BE USED, IN WHOLE OR IN PART, FOR ANY OTHER PROJECT WITHOUT THE WRITTEN AUTHORIZATION OF CHM HILL.

BAR IS ONE INCH ON ORIGINAL DRAWING.
IF NOT ONE INCH ON THIS SHEET, ADJUST SCALES ACCORDINGLY.

CAPE MAY MUNICIPAL UTILITY AUTHORITY
CAPE MAY COUNTY NEW JERSEY
WILDWOOD/LOWER REGION
OCEAN OUTFALL

**PROFILE MARINE PORTION
(STEEL PIPE)**

SHEET 2A
DWG NO.
DATE JULY 1986
PROJ NO. W18167.G3