

TENTH AVE. PUMP STATION

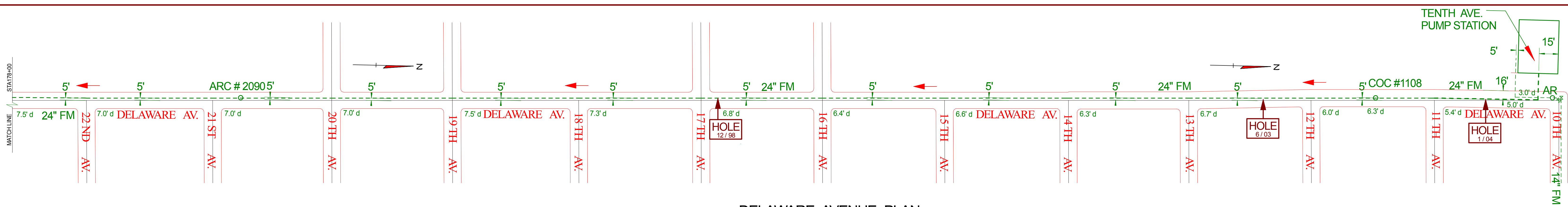

DELAWARE AVENUE PLAN
SCALE: 1" = 100'

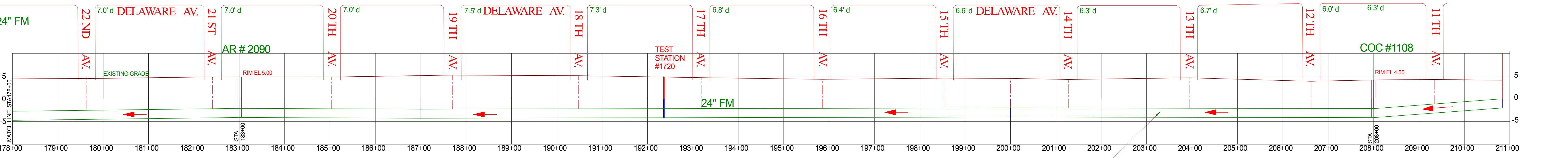

24 INCH F.M. PROFILE
1" = 100' HORZ.
1" = 10' VERT

REHABILITATE EXISTING 24" SEWAGE FORCE MAIN

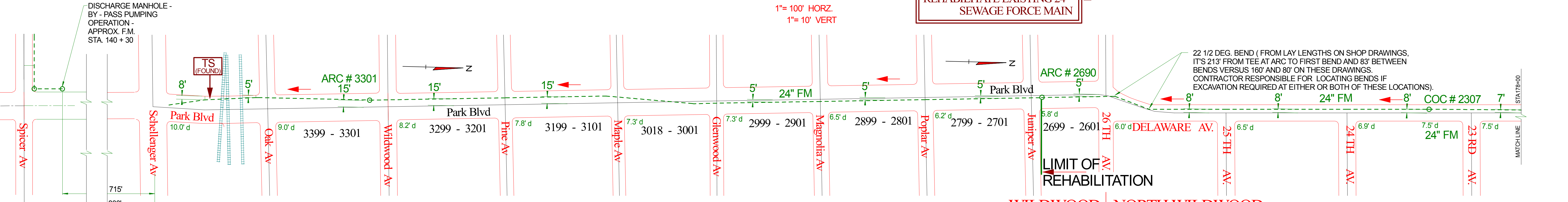

PARK BLVD. PLAN
SCALE: 1" = 100'

DELAWARE AVENUE PLAN
SCALE: 1" = 100'

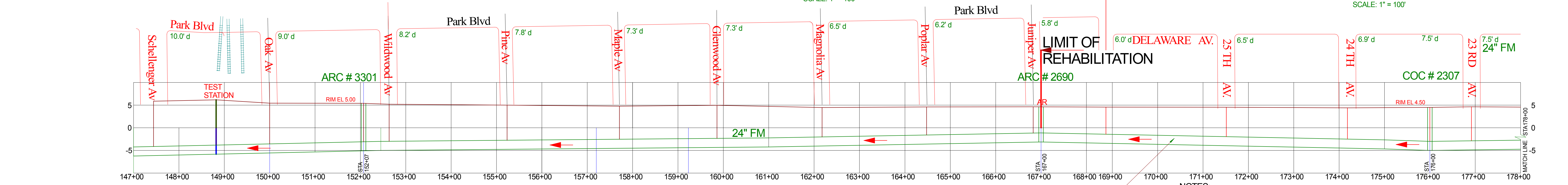

24 INCH F.M. PROFILE
1" = 100' HORZ.
1" = 10' VERT

REHABILITATE EXISTING 24" SEWAGE FORCE MAIN

- GENERAL SCOPE OF WORK:**
- THE SCOPE OF WORK INCLUDES REHABILITATION OF THE EXISTING 24-INCH DUCTILE IRON PIPE FORCE MAIN FROM THE EXISTING TENTH AVENUE PUMP STATION ON DELAWARE AVENUE TO THE EXISTING AIR RELEASE CHAMBER AT APPROXIMATELY JUNIPER AVENUE ON PARK BLVD. (TOTAL LENGTH APPROXIMATELY 4,500 FEET). THE APPROVED METHOD IS SLIP LINING WITH 22-INCH O.D. SDR 21 HDPE PIPE.
 - THE CONTRACTOR SHALL DEVELOP A TRAFFIC CONTROL PLAN IN ACCORDANCE WITH THE MANUAL OF UNIFORM TRAFFIC CONTROL DEVICES AND OBTAIN APPROVAL FROM THE NORTH WILDWOOD AND WILDWOOD POLICE DEPARTMENTS, AND THE CMCMAA.
 - SEWAGE FLOW SHALL BE MAINTAINED DURING THE WORK VIA A TEMPORARY BYPASS PIPING SYSTEM FROM THE EXISTING TENTH STREET PUMP STATION TO A MANHOLE JUST NORTH OF SPICER AVENUE ON PARK BOULEVARD. THE DESIGN AND OPERATION OF THE BYPASS SYSTEM SHALL BE THE RESPONSIBILITY OF THE CONTRACTOR. REFER TO THE SPECIFICATIONS FOR MORE INFORMATION ON THE BYPASS PIPING SYSTEM.
 - PRIOR TO REHABILITATION, INCLUDE CLEANING AND VIDEO OF THE FORCE MAIN AND POST VIDEO AFTER REHABILITATION. ALSO REFER TO THE SPECIFICATIONS FOR REQUIREMENTS FOR CLEANING, VIDEO AND REHABILITATION WORK.

- GENERAL UTILITY NOTES:**
- PROFILE INVERT DEPTH FROM EXISTING RECORD DRAWINGS INCLUDED AT END OF DRAWING SET. CONTRACTOR IS CAUTIONED THAT PIPELINE AND CHAMBERS MAY HAVE EXPERIENCED SETTLEMENT. PIPE DEFLECTIONS SHALL BE CONFIRMED WITH TELEVISED VIDEO OF PIPE INTERIOR.
 - FOR UTILITY LOCATIONS - SEE ATTACHED REFERENCE DRAWINGS AND CALL FOR MARKOUTS.

- NOTES:**
- PIPE IS CLASS 51 DUCTILE IRON PIPE WITH 40 MIL POLYETHYLENE BONDED INTERIOR LINING, BITUMASTIC COATING, POLYETHYLENE BAG WRAP AND JOINTS ARE BONDED FOR ELECTRICAL CONTINUITY.
 - DEPTHS SHOWN ON THE PROFILE ARE APPROXIMATE DEPTH TO TOP OF PIPE.
 - CHAMBERS PROVIDE ACCESS TO THE PIPE BUT REQUIRE PUMP OUT OF GROUNDWATER.
 - ARC = AIR RELEASE CHAMBER, COC = CLEAN OUT CHAMBER, TS = TEST STATION

- LEGEND**
- ARC # AIR RELEASE CHAMBER (IN FRONT OF HOUSE NUMBERED)
 - COC # CLEAN OUT CHAMBER (IN FRONT OF HOUSE NUMBERED)
 - Flow Direction

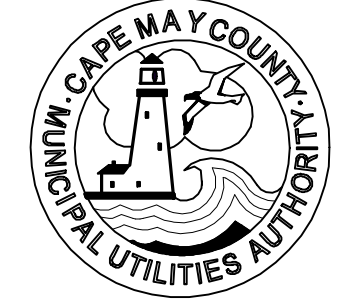

MANLEY C. SOLHEIM, JR.
PROFESSIONAL ENGINEER

REVISION	DATE	DESCRIPTION	APP'D.
WILDWOOD / LOWER REGION 24 - INCH F.M. REHABILITATION NORTH WILDWOOD, NEW JERSEY			
CAPE MAY COUNTY MUNICIPAL UTILITIES AUTHORITY ENGINEERING DEPARTMENT			
P.O. BOX 610 CAPE MAY COURT HOUSE NEW JERSEY 08210		CONTRACT NO.:	
DESIGN: MCS	DRAWN: HRS	SCALE: AS SHOWN	
CHECKED: MCS	APPROVED: MCS	DATE: FEBRUARY, 2004	
FORCE MAIN			DRAWING NO.
PLAN AND PROFILE			2 OF 3